

# ActIn Time

SQL Employee Management System

Shipped **FREE** with Microsoft SQL Sever Express



ActIn Time increases your company's productivity by improving your employees time keeping.

## ActIn Time

ActIn Time is the UK's leading British manufactured SQL Time & Attendance workforce management system for medium to large businesses. This product suite contains everything you need, to help you efficiently organise and maintain accurate staff records in one simple, easy to use software package for unlimited employees.

### How it works!



- Employees clock using an array of clocking terminals.
- Clocking data is collected from the terminals via network.
- View and edit employee data.
- Produce reports to print or export to a file.
- Export payroll data to your Payroll Package.

### ActIn Time - Main Modules

#### Attendance

Calculates all types of shift rules and overtime including flexible working hours i.e. Flexitime.



#### Absence Management

Track holiday entitlement, absence, lateness and core time infringements.



### HR / Personnel

Keep all your personnel data in one place.



### Access Control | Mustering

Secure your company's doors, barriers or entrance gates for Health & Safety.



### Fire Roll Call

Automatically unlock doors, link to fire alarm and send a roll-call report in the event of a fire.



### Reporting

Over 160 clear, concise, and user editable, reports, forms and graphs.



### Job Costing

Monitoring of job and operations worked by employees.



### (PIP) Personal Information Portal

Give employees access to their own attendance and absence information.



### Other Main Modules Inc:

- Health and Safety
- Email Me!
- Employee Self Service
- Multi Site
- Multi Terminal
- Rostering
- Scripting
- Payroll Export
- Flexitime

### ActIn Time - Hardware Terminals



### Features

- Business in / business out
  - Holiday entitlement request
  - Hours worked request
  - Manual end of schedule
  - Manual break button
  - Manual schedule selection
  - Bell ringing or door release (Driven by relay)
  - USB Optional
  - GPRS Optional
- \*Not all features available on Hand Punch terminals

The ActIn Time hardware terminals can be configured in the following ways:

Magnetic Swipe - Swipe Card

Proximity - Card or Fob

Fingerprint - Finger Only, Finger, Card / Fob, Finger and Pin, Finger and Password

Hand Punch - Hand and Pin

## ActIn Time - Access Control



## Features

- Site code specification
- 2 reader inputs
- 2 relay outputs ideal for door, barrier and turnstile control.
- Door ajar alert
- Door force alert
- Fire alarm input
- USB Optional
- GPRS Modem Optional

## Additional Add 'ons' and Accessories

- Pre - Programmed system with import of employee details & up to 10 daily shift rules.
- Automatic Payroll Link to your preferred payroll software package i.e. Sage / Pegasus.
- GSM Modems
- External Readers
- USB Desktop Readers
- Finger Desktop Readers
- Employee Badges
- Card Racks
- ID Card & Printers
- ID Bureau Service
- ID Accessories & Supplies

## Specification

- Compatible with Windows 7, Vista & XP
- Servers 2008/2003/2000
- 32 & 64 Bit operating systems

## Minimum PC & Server Requirements

- Processor - Pentium IV 2.5GHZ
- RAM - 1GB
- Hard drive Space (minimum 2GB available of C Drive for install) - 1GB
- SQL Version - Microsoft SQL MSDE (Shipped **FREE**)
- Compatible with - SQL Server 2000 / 2005 / 2008 32 / 64 Bit
- Colour Monitor Resolution - 800 X 600
- USB socket required (for dongle registration)

## ActIn Time Schematic

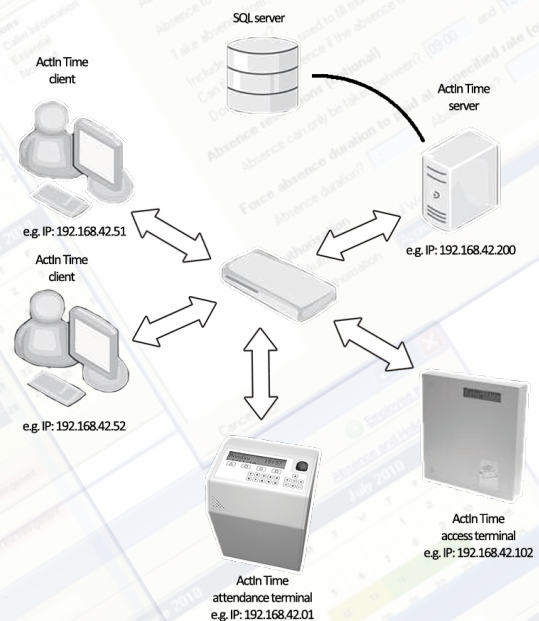

**wisegrove limited**  
workforce management solutions

60 Hoppers Road, London, N21 3LH  
T: 020 8882 4522 F: 020 8886 1547  
www.wisegrove.co.uk info@wisegrove.co.uk



Compatible with:  
**Microsoft SQL Server 2008**



Shipped with the **FREE**:  
**Microsoft SQL Server 2008 R2 Express**